

# *The Sawgrass*

---



Designed with a stately presence, "The Sawgrass" has thoughtful details throughout, balancing an open-concept and Lowcountry-traditional design. The gracious screened porch and outdoor rear porch allows you to enjoy the beautiful outdoors throughout the year.



## *Sawgrass Features*

- 4,045 Heated Square Feet
- 172 Square Feet of Front Porch
- 636 Square Feet of Rear/Screened Porches
- 6 bedrooms
- 3.5 baths (Plus, Optional Pool Bath)
- First Floor Office/Flex Room
- 2 Car Garage (Optional 3 Car)
- 2246 Square Foot Lower Level Foundation

**[www.AxonHomes.com](http://www.AxonHomes.com)**

# The Sawgrass

## FLOOR PLAN

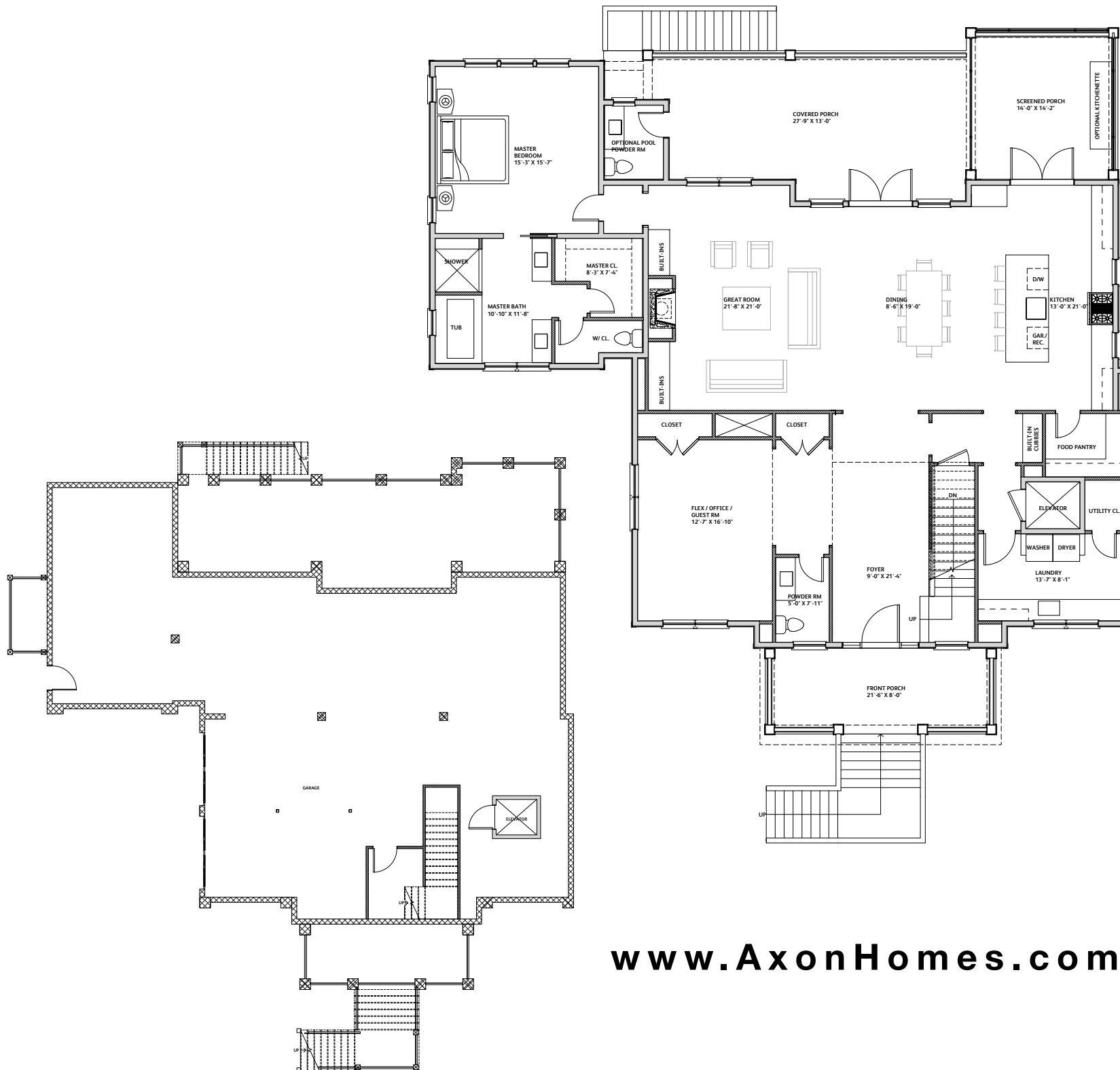

[www.AxonHomes.com](http://www.AxonHomes.com)

